

☆☆☆ 265 Series ☆☆☆

P/N: W265V**G00

Material: PBT with Glass-Filled, UL 94V-0, Black

Conductor: Brass, Gold-Flash

Available: 2~15P

Mate with H265

REVISIONS			
REV	DESCRIPTION	DATE	DRAWN
A			

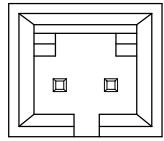

2P

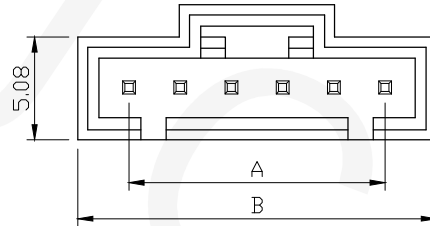

RECOMMENDED P.C.BOARD HOLE DIMM.

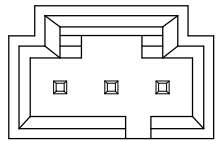

3P

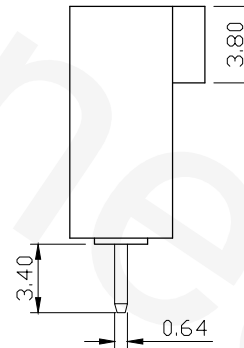
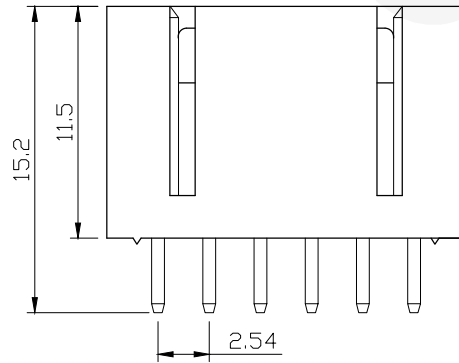

Circuitis	Dim. A	Dim. B
2	2.54	7.62
3	5.08	10.16
4	7.62	12.70
5	10.16	15.24
6	12.70	17.78
7	15.24	20.32
8	17.78	22.86
9	20.32	25.40
10	22.86	27.94
11	25.40	30.48
12	27.94	33.02
13	30.48	35.56
14	33.02	38.10
15	35.56	40.64

RoHS Compliant



TEL: 886-2-86871898 FAX: 886-2-86872959
 Mail: tceldh@gmail.com Web: http://www.cnj.tw/

TITLE

.100"(2.54mm) Wire to Board Vertical Wafer

DIMENSION TOLERANCE

.x ±0.30 x° ±2°
 .xx ±0.20
 .xxx ±0.10

P/N	W265V**G00	CHECKED	David	UNIT	mm	DATE	2010/08/27
DRAWN	Michael	APPROVED	Lily	SCALE	1:1	REV	A

☆☆☆ 265 Series ☆☆☆

P/N: W265H**G00

Material: PBT with Glass-Filled, UL 94V-0

Conductor: Brass, Gold-Flash

Available: 2~16P

Mate with H265

REVISIONS			
REV	DESCRIPTION	DATE	DRAWN
A			

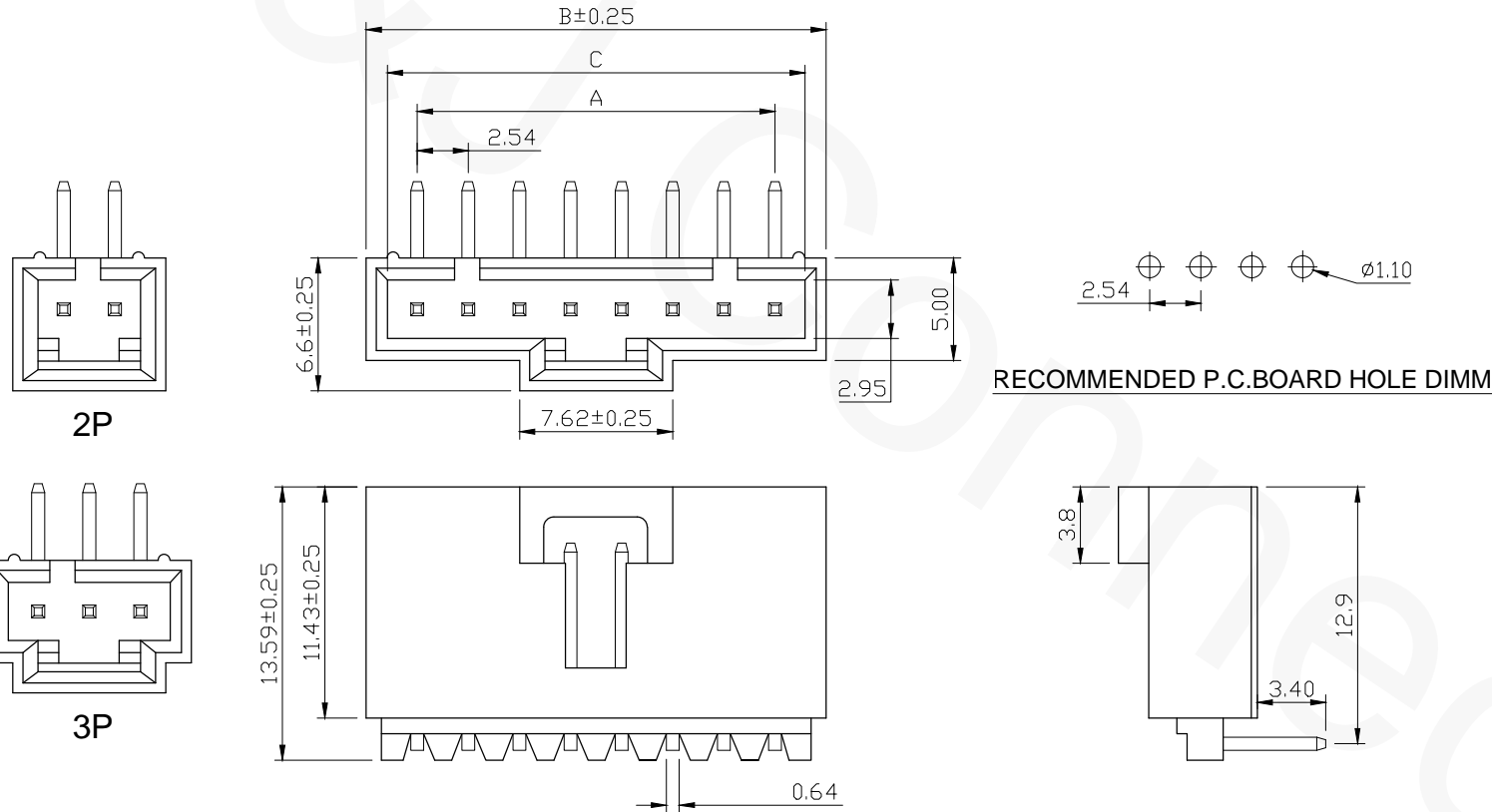

Circuitis	Dim. A	Dim. B	Dim. C
2	2.54	7.62	5.52
3	5.08	10.16	8.06
4	7.62	12.70	10.60
5	10.16	15.24	13.14
6	12.70	17.78	15.68
7	15.24	20.32	18.22
8	17.78	22.86	20.76
9	20.32	25.40	23.30
10	22.86	27.94	25.84
11	25.40	30.48	28.38
12	27.94	33.02	30.92
13	30.48	35.56	33.46
14	33.02	38.10	36.00
15	35.56	40.64	38.54

RoHS Compliant



TEL: 886-2-86871898 FAX: 886-2-86872959
 Mail: tceldh@gmail.com Web: http://www.cnj.tw/

TITLE
 .100"(2.54mm) Wire to Board Horizontal Wafer

DIMENSION TOLERANCE	
.x	±0.15
.xx	±0.10
.xxx	±0.05

P/N	W265H**G00	CHECKED	David	UNIT	mm	DATE	2010/08/27
DRAWN	Michael	APPROVED	Lily	SCALE	1:1	REV	A

☆☆☆ 265 Series ☆☆☆

P/N: H265S**000

Material: PBT with Glass-Filled, UL 94V-0, Black

Available: 2~10P

Mate with W265

Current Rating: 3A AC,DC

Voltage Rating: 250V AC,DC

RoHS Compliant

QoS Compliant

Withstanding Voltage: 1500V AC/minute

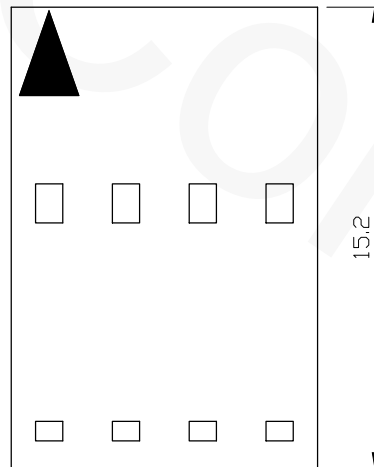
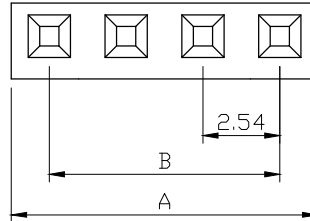

2.54

REVISIONS			
REV	DESCRIPTION	DATE	DRAWN
A			

Circuitis	Dim. A	Dim. B
2	5.08	2.54
3	7.62	5.08
4	10.16	7.62
5	12.70	10.16
6	15.24	12.70
7	17.78	15.24
8	20.32	17.78
9	22.86	20.32
10	25.40	22.86

RoHS Compliant

 **C&J Connector**

TEL: 886-2-86871898 FAX: 886-2-86872959
 Mail: tceldh@gmail.com Web: <http://www.cnj.tw/>

TITLE
 .100"(2.54mm) Wire to Board Housing

DIMENSION TOLERANCE

.x	±0.10	φ	±0.10
.xx	±0.05		
.xxx	±0.02		

P/N	H265S**000	CHECKED	David	UNIT	mm	DATE	2010/08/06
DRAWN	Michael	APPROVED	Lily	SCALE	1:1	REV	A

A

B

C

D

E

F

☆☆☆ 265 Series ☆☆☆

P/N: H265S**0D0

Material: PBT + 15% Glass-Filled, UL 94V-0, Black

Available: 2~25P

Mate with W265

Current Rating: 3A AC,DC

Voltage Rating: 250V AC,DC

Operating Temperature: -40°C to +105°C

Storage Temperature: -40°C to +125°C

Withstanding Voltage: 1500V AC/minute

REVISIONS			
REV	DESCRIPTION	DATE	DRAWN
A			

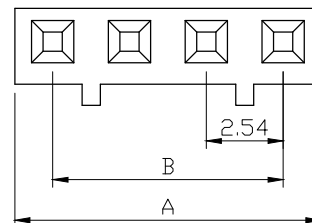

2P

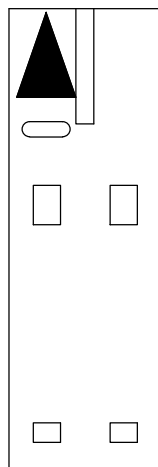

3P

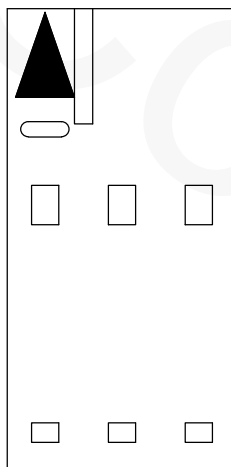

4~25P

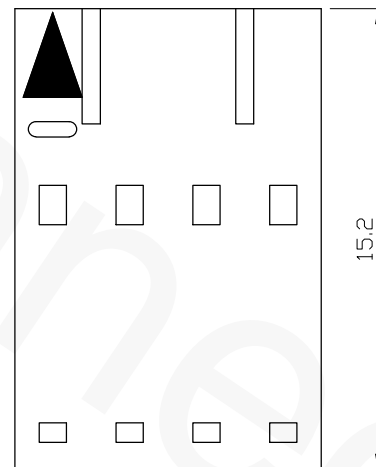

2.54

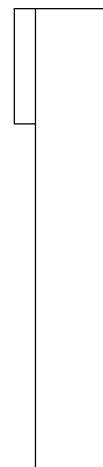

RoHS Compliant



TEL: 886-2-86871898 FAX: 886-2-86872959
Mail: tceldh@gmail.com Web: http://www.cnj.tw/

TITLE

.100"(2.54mm) Wire to Board Housing

DIMENSION TOLERANCE

.x	±0.15	φ	±0.1
.xx	±0.10		
.xxx	±0.05		

P/N	H265S**0D0	CHECKED	David	UNIT	mm	DATE	2010/08/06
DRAWN	Michael	APPROVED	Lily	SCALE	1:1	REV	A

A

B

C

D

E

F

REVISIONS

REV	DESCRIPTION	DATE	DRAWN
A			

☆☆☆ **265 Series** ☆☆☆

P/N: H265S**0L0

Material: PBT with Glass-Filled, UL 94V-0, Black

Available: 2~16P

Mate with W265

Current Rating: 3A AC,DC

Voltage Rating: 250V AC,DC

RoHS Compliant

UL 94V-0, Black

Withstanding Voltage: 1500V AC/minute

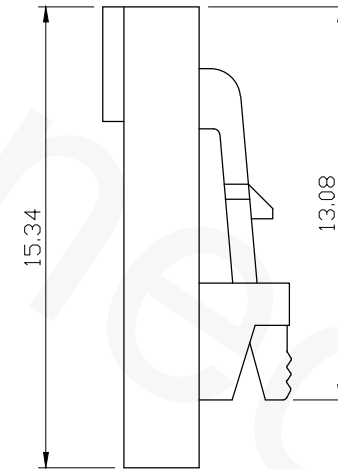
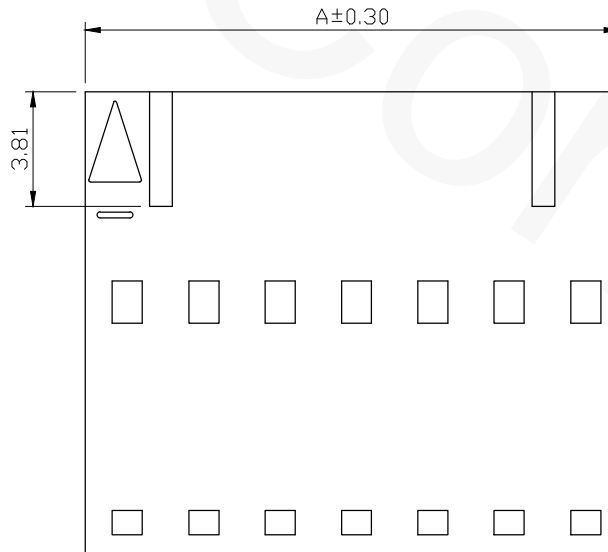
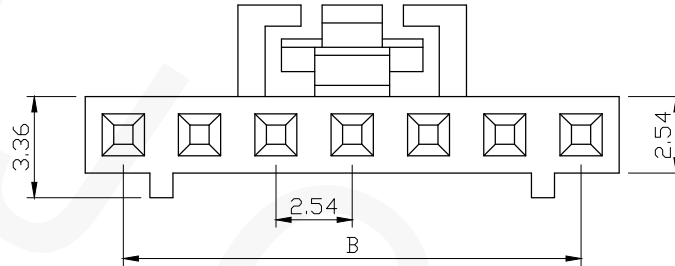

Circuitis	Dim. A	Dim. B
2	5.08	2.54
3	7.62	5.08
4	10.16	7.62
5	12.70	10.16
6	15.24	12.70
7	17.78	15.24
8	20.32	17.78
9	22.86	20.32
10	25.40	22.86
11	27.94	25.40
12	30.48	27.94
13	33.02	30.48
14	35.56	33.02
15	38.10	35.56
16	40.64	38.10

RoHS Compliant

 **C&J Connector**

TEL: 886-2-86871898 FAX: 886-2-86872959
Mail: tceldh@gmail.com Web: <http://www.cnj.tw/>

TITLE

.100"(2.54mm) Wire to Board Housing

DIMENSION TOLERANCE

.x ±0.15mm φ ±0.15mm
.xx ±0.20mm
.xxx ±0.25mm

P/N	H265S**0L0	CHECKED	David	UNIT	mm	DATE	2010/08/06
DRAWN	Michael	APPROVED	Lily	SCALE	1:1	REV	A

A

B

C

D

E

F

☆☆☆ 265 Series ☆☆☆

P/N: T265P00G00

Conductor: Brass/ GOLD-FLASH

Thickness: 0.2mm

REVISIONS			
REV	DESCRIPTION	DATE	DRAWN
A			

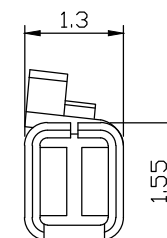
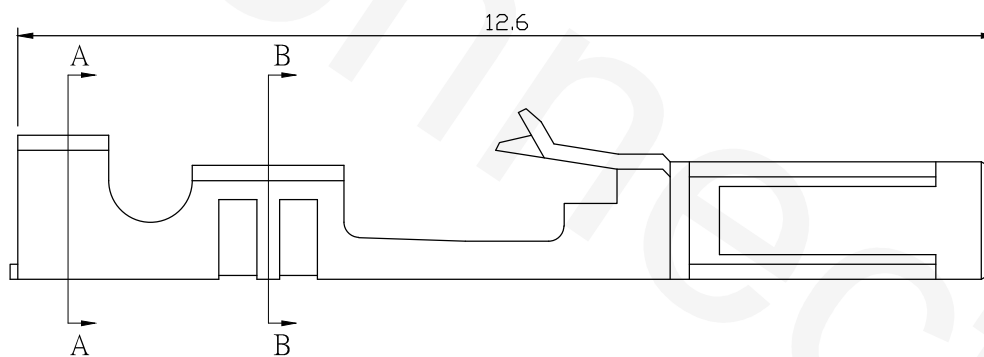
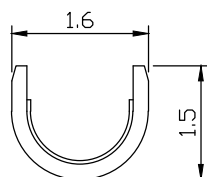
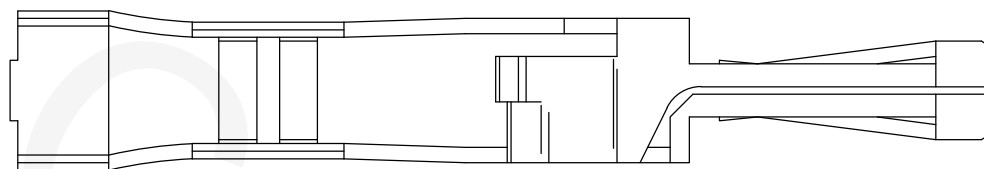
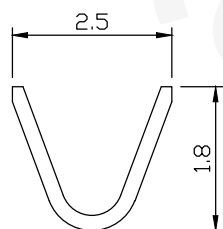

RoHS Compliant



C&J Connector

TEL: 886-2-86871898 FAX: 886-2-86872959
 Mail: tceldh@gmail.com Web: http://www.cnj.tw/

TITLE

.100"(2.54mm) Crimp Terminal

DIMENSION TOLERANCE

.x ±0.30 x° ±2°

.xx ±0.20

.xxx ±0.10

P/N	T265P00G00	CHECKED	David	UNIT	mm	DATE	2010/08/04
DRAWN	Michael	APPROVED	Lily	SCALE	1:1	REV	A

A

B

C

D

E

F