

☆☆☆ 306 Series ☆☆☆

P/N: W306H**T00

Material: Nylon 6/6, UL 94V-2

Conductor: Brass, Tin-Plated

Available: 2~10P

Mate with H306

Current Rating: 7A AC/DC

Voltage Rating: 250V AC/DC

Contact Resistance: 10mΩ MAX.

Withstand Voltage: 1500V AC/Minute

Insulation Resistance: 1000MΩ Min.

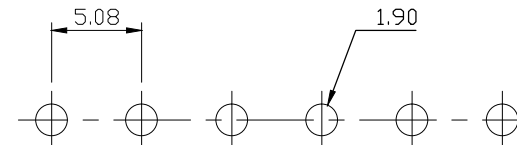
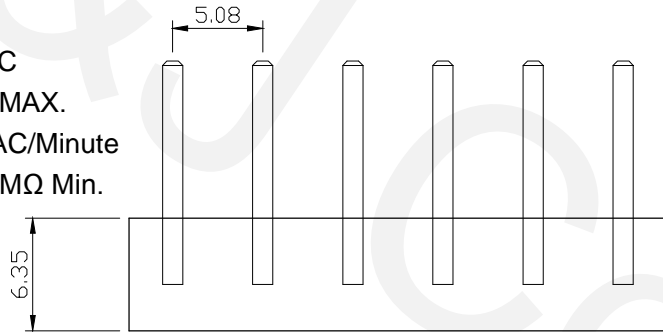

RECOMMENDED P.C.BOARD HOLE DIMM.

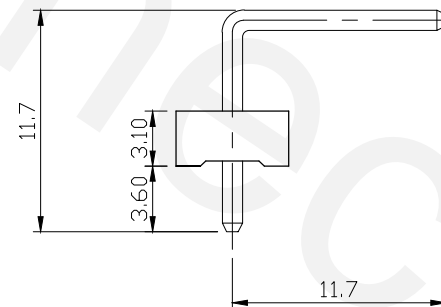
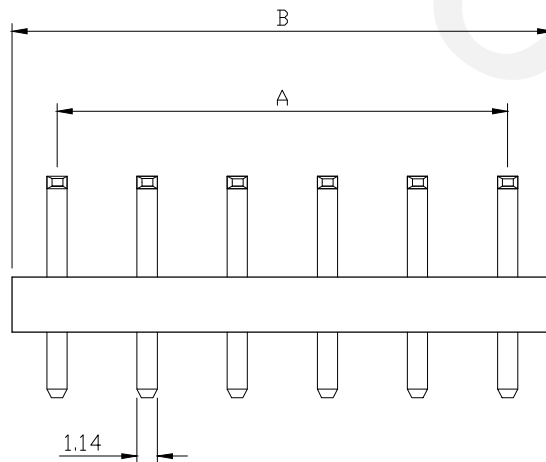

Circuitis	Dim. A	Dim. B
2	5.08	10.16
3	10.16	15.24
4	15.24	20.32
5	20.32	25.40
6	25.40	30.48
7	30.48	35.56
8	35.56	40.64
9	40.64	45.72
10	45.72	50.80

RoHS Compliant



TEL: 886-2-86871898 FAX: 886-2-86872959
Mail: tceldh@gmail.com Web: http://www.cnj.tw/

TITLE

.200"(5.08mm) Wire to Board Horizontal Wafer

DIMENSION TOLERANCE

.x ±0.30 x° ±2°
.xx ±0.20
.xxx ±0.10

P/N	W306H**T00	CHECKED	David	UNIT	mm	DATE	2010/08/31
DRAWN	Michael	APPROVED	Lily	SCALE	1:1	REV	A

REVISIONS			
REV	DESCRIPTION	DATE	DRAWN
A			

☆☆☆ 306 Series ☆☆☆

P/N: W306V**T00

Material: Nylon 6/6, UL 94V-2, Natural

Conductor: Brass, Tin-Plated

Available: 2~10P

Mate with H306

Current Rating: 5A AC/DC

Voltage Rating: 250V AC/DC

Contact Resistance: 10mΩ MAX.

Withstand Voltage: 1500V AC/Minute

Insulation Resistance: 1000MΩ Min.

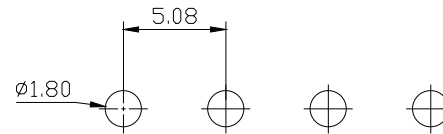

RECOMMENDED P.C.BOARD HOLE DIMM.

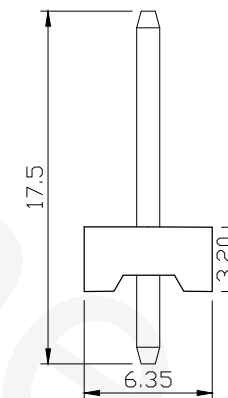
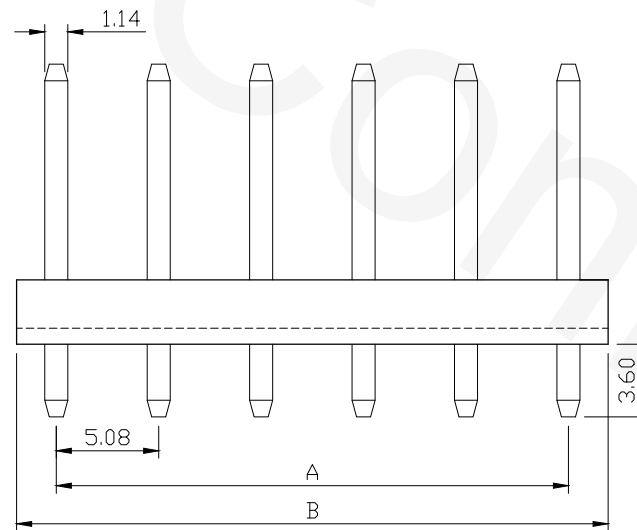

REVISIONS

REV	DESCRIPTION	DATE	DRAWN
A			

Circuitis	Dim. A	Dim. B
2	5.08	10.16
3	10.16	15.24
4	15.24	20.32
5	20.32	25.40
6	25.40	30.48
7	30.48	35.56
8	35.56	40.64
9	40.64	45.72
10	45.72	50.80

RoHS Compliant



TEL: 886-2-86871898 FAX: 886-2-86872959
Mail: tceldh@gmail.com Web: http://www.cnj.tw/

TITLE

.200"(5.08mm) Wire to Board Vertical Wafer

DIMENSION TOLERANCE

.x ±0.30 x° ±2°
.xx ±0.20
.xxx ±0.10

P/N	W306V**T00	CHECKED	David	UNIT	mm	DATE	2010/08/31
DRAWN	Michael	APPROVED	Lily	SCALE	1:1	REV	A