

☆☆☆ DisplayPort ☆☆☆

P/N: MDP-20D9L3PH3

Body: LCP+50%GF, UL 94V-0, White

Insert(Molding): LCP+30%GF, UL 94V-0, Black

Clip: PA66+30%GF, UL 94V-2, Black

Plating: Contact Area: Au

Solder Tail: Sn 100u" Min.

Underplating Overall: Ni 40u" Min.

Shell: Brass, Ni Plating 40u"~80u"

Current Rating: 0.5A per Contact

Voltage Rating: 30V AC Max.

Contact Resistance: 30mΩ Max.

Insulation Resistance: 100MΩ Min.

Withstanding Voltage: 500V AC/minute

Operating Temperature Range: -40°~85°C

Insertion Force: 4.5Kgf. Max.

Withdrawal Force: 1.0~4.0Kgf.

Durability: 10000 cycles

RoHS Compliant

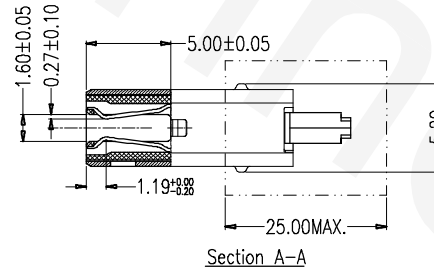
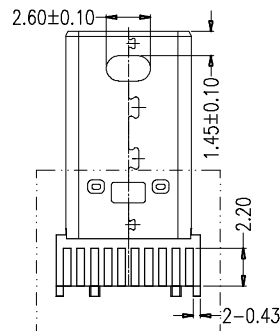
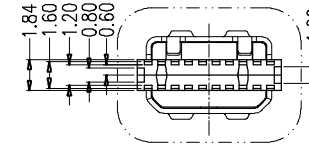
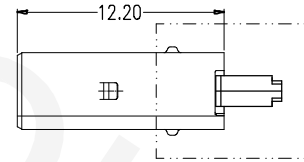
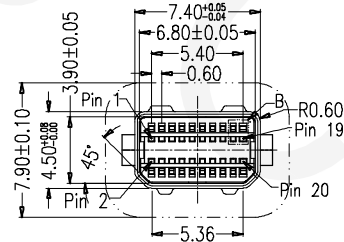
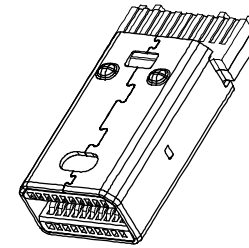
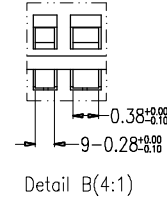
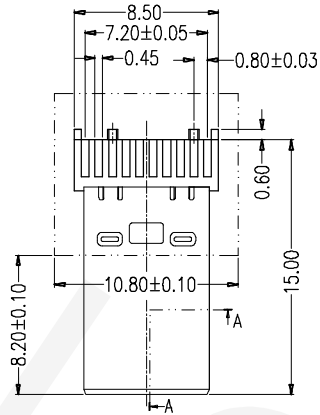

Top Row		
Pin #	Signal Type	Pin Name
1	GND	GND
3	Out	ML Lane 3(n)
5	Out	ML Lane 3(p)
7	GND	GND
9	Out	ML Lane 2(n)
11	Out	ML Lane 2(p)
13	GND	GND
15	Out	ML Lane 1(n)
17	Out	ML Lane 1(p)
19	GND	GND

Bottom Row		
Pin #	Signal Type	Pin Name
2	In	Hot Plug Detect
4	Config	Config 1
6	Config	Config 2
8	GND	GND
10	Out	ML Lane 0(n)
12	Out	ML Lane 0(p)
14	GND	GND
16	I/O	AUX CH(p)
18	I/O	AUX CH(n)
20	Power Out	DP Power

TITLE

Mini DisplayPort Plug(Sector) Match Wire Clip

DIMENSION TOLERANCE

.x ±0.38 x° ±5°
.xx ±0.25
.xxx ±0.20

TEL: 886-2-86871898 FAX: 886-2-86872959
Mail: tceldh@gmail.com Web: http://www.cnj.tw/

P/N	MDP-20D9L3PH3	CHECKED	David	UNIT	mm	DATE	2012/03/26
DRAWN	Michael	APPROVED	Lily	SCALE	1:1	REV	A

☆☆☆ DisplayPort ☆☆☆

P/N: MDR-20FAL1PH4

Body: LCP+50%GF, UL 94V-0, Black

Insert(Molding): LCP+30%GF, UL 94V-0, Black

Retainer: LCP+50%GF, UL 94V-0, Black

Contact: Phosphor Bronze

Plating: Contact Area: Au over Ni(40u"~80u")

Solder Tail: Sn 100u" Min.

Shell: Brass, Ni Plating 40u"~80u"

Current Rating: 0.5A per Contact

Contact Resistance: 30mΩ Max.

Insulation Resistance: 100MΩ Min.

Withstanding Voltage: 500V AC/minute

Operating Temperature Range: -40°~85°C

Insertion Force: 4.5Kgf. Max.

Withdrawal Force: 1.0~4.0Kgf.

Durability: 10000 cycles

RoHS Compliant

Unit:mm

Part NO.	Dim A	P.C.B Thickness
MDR-20FBL1PH4	3.10	1.60
MDR-20FAL1PH4	2.15~2.30	1.20

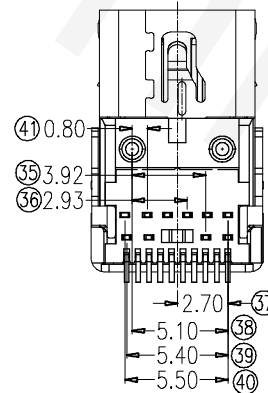
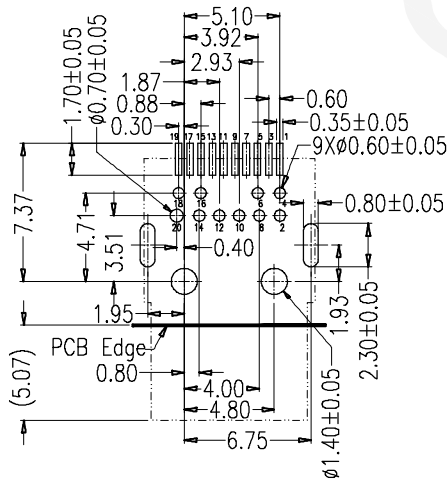
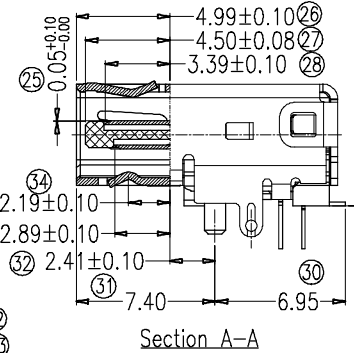
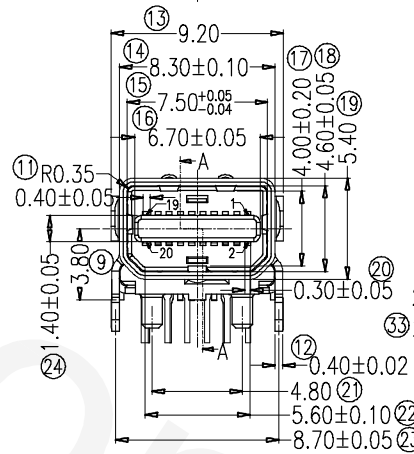
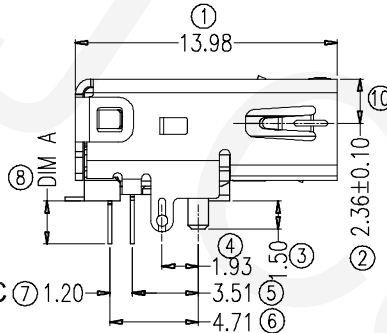
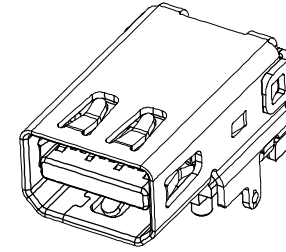
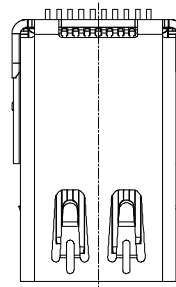

Top Row		
Pin #	Signal Type	Pin Name
1	GND	GND
3	Out	ML Lane 0(p)
5	Out	ML Lane 0(n)
7	GND	GND
9	Out	ML Lane 1(p)
11	Out	ML Lane 1(n)
13	GND	GND
15	Out	ML Lane 2(p)
17	Out	ML Lane 2(n)
19	GND	GND

Bottom Row		
Pin #	Signal Type	Pin Name
2	In	Hot Plug Detect
4	Config	Config 1
6	Config	Config 2
8	GND	GND
10	Out	ML Lane 3(p)
12	Out	ML Lane 3(n)
14	GND	GND
16	I/O	AUX CH(p)
18	I/O	AUX CH(n)
20	Power Out	DP Power



TEL: 886-2-86871898 FAX: 886-2-86872959
Mail: tceldh@gmail.com Web: http://www.cnj.tw/

TITLE
Mini DisplayPort Receptacle DIP+SMT(Apple 3.8) Black

DIMENSION TOLERANCE
.x ±0.38 x° ±5°
.xx ±0.25
.xxx ±0.20

P/N	MDR-20FAL1PH4	CHECKED	David	UNIT	mm	DATE	2012/03/26
DRAWN	Michael	APPROVED	Lily	SCALE	1:1	REV	A